

ROHS

THIS IS A RoHS COMPLIANT COMPONENT/PRODUCT.

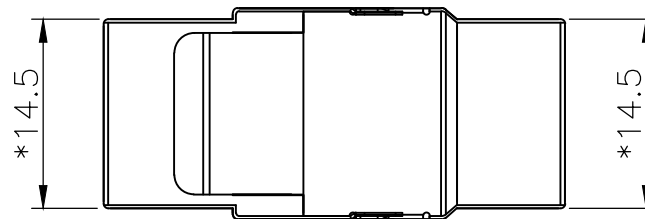
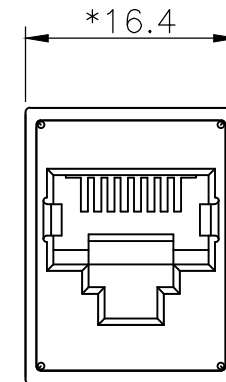
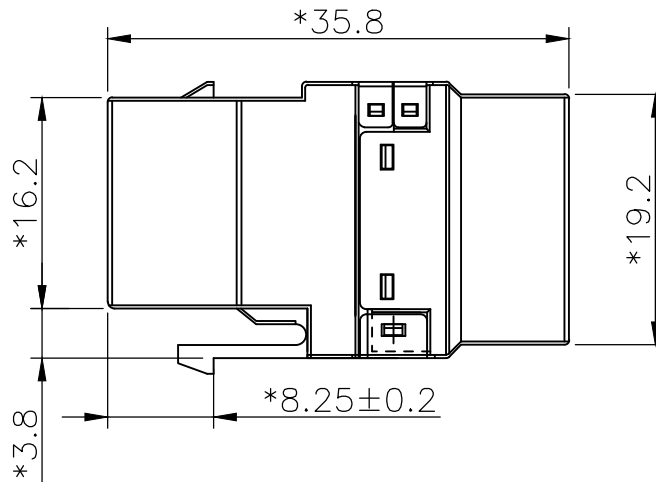
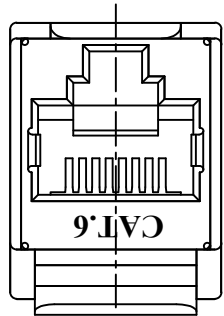

NOTES:

ELECTRICAL:

- 1. VOLTAGE RATING : 125 VAC
- 2. CURRENT RATING : 1.5 AMP.
- 3. CONTACT RESISTANCE : 100 MILLIOHMS MAX.
- 4. INSULATION RESISTANCE : 1000 MEGOHMS MIN. @ 500 VDC.
- 5. DIELECTRIC STRENGTH : 750 VAC 60Hz, 1MIN.

MECHANICAL:

- 1. HOUSING MATERIAL : PC UL94V-0
- 2. INSERT MATERIAL : GLASS FILLED POLYESTER UL94V-0 BK.
- 3. PCB MATERIAL : FR-4 THICKNESS 1.6mm
- 4. CONTACT MATERIAL : PHOSPHOR BRONZE STAMP PIN t=0.35mm
- 5. SHIELD MATERIAL : COPPER ALLOY 0.25mm THICKNESS NICKEL PLATING

ENVIRONMENTAL:

- 1. STORAGE: -40°C TO +85°C.
- 2. OPERATION: -40°C TO +85°C
- MATES WITH MODULAR PLUG CONFORMING TO TIA-1096-A.

PART NUMBER: N446X-001-01

- 1-3u" 2-6u"
- 3-15u" 4-30u"
- 5-50u"

△	0069000	NEW DESIGN	HENRY	051616'
MARK	ECN-NO.	REVISION RECORD	DRAWN	DATE
 Contact Technology Co., Ltd.	UNLESS OTHERWISE SPECIFIED TOLERANCE Dimension Range Tolerance		SCALE	CHECKED
	X.X	±0.20	UNIT	APPROVED
	X.XX	±0.15	mm	
	X.XXX	±0.10	SIZE	
Material/Plated/Notes		ANGLE	A3	SHEET 1/1
SEE NOTE		NAME	CAT.6 COUPLER STP	
Tooling No.		PART NO.	N446X-001-01	REV. 0
		DOC. NO.	NN446A001	