

RoHS

THIS IS A RoHS
COMPLIANT
COMPONENT/
PRODUCT.

NOTES:

ELECTRICAL:

1. VOLTAGE RATING: 125 VAC RMS.
2. CURRENT RATING: 1.5 AMP.
3. CONTACT RESISTANCE: 100 MILLIOHMS MAX.
4. INSULATION RESISTANCE: 1000 MEGOHMS MIN @ 500 VDC.
5. DIELECTRIC STRENGTH: 750 VAC RMS 60Hz, 1MIN.
6. C6A CONNECTING HARDWARE:
CONFORM TO ANSI/TIA/EIA-568.2-D

ENVIRONMENTAL:

1. STORAGE: -40°C TO +85°C.
 2. OPERATION: -40°C TO +85°C.
- CONFORM TO TIA/EIA 568B
MATES WITH MODULAR PLUG CONFORMING TO
TIA-1096-A.

MECHANICAL:

1. HOUSING MATERIAL: ZINC ALLOY-3, WITH NICKEL PLATING
 2. INSERT & COVER MATERIAL: PC UL94V-0
 3. PCB MATERIAL: FR-4
 4. CONTACT MATERIAL: PHOSPHOR BRONZE
 5. IDC CONTACT MATERIAL: PHOSPHOR BRONZE
WITH SILVER OR NICKEL PLATING
 6. WIRE : AWG 23~26
 7. PART NUMBER: N4455-014-0X
- 02:W/C6A LOGO

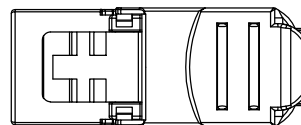
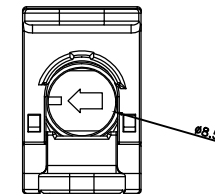
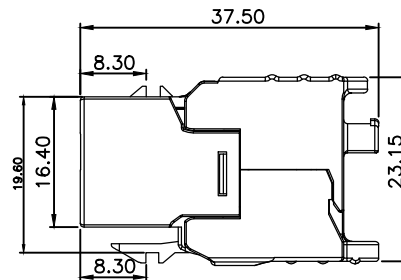
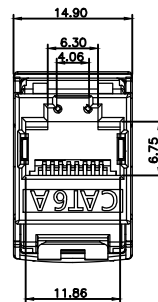
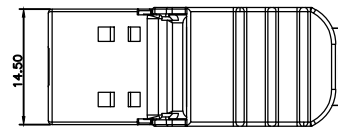
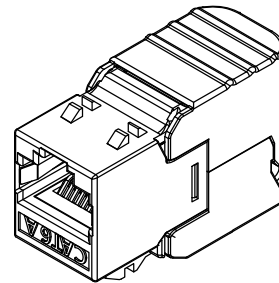

△X0	0069000	NEW DESIGN	HENRY	122719'
MARK	ECN-NO.	REVISION RECORD	DRAWN	DATE
CTK	UNLESS OTHERWISE SPECIFIED TOLERANCE		SCALE	CHECKED
	Dimension Range	Tolerance	1:1	APPROVED
	X.X	±0.20	UNIT	
	X.XX	±0.15	mm	
X.XXX	±0.10	SIZE	A3	
ANGLE	±5°			
Material/Plated/Notes		NAME		
SEE NOTE		CAT.6A TOP ENTRY SLIM TYPE KEYSTONE JACK FTP		
Tooling No.	PART NO.	SEE NOTE	REV.	
	DOC. NO.	NN445A014	0	