

**RoHS** THIS IS A RoHS COMPLIANT COMPONENT/PRODUCT.

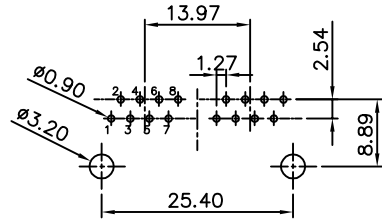
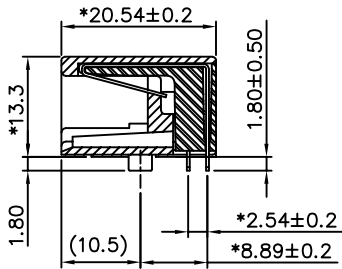
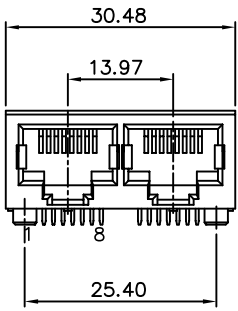

PC Board Layout  
Component Side Shown

**NOTES:**

**ELECTRICAL:**

1. VOLTAGE RATING : 125 VAC RMS.
2. CURRENT RATING : 1.5 AMP.
3. CONTACT RESISTANCE : 45 MILLIOHMS MAX.
4. INSULATION RESISTANCE : 1000 MEGOHMS MIN. @ 500 VDC.
5. DIELECTRIC STRENGTH : 1000 VAC RMS 60Hz, 1MIN.

**MECHANICAL:**

1. HOUSING MATERIAL : HIGH TEMP. UL94V-0.
2. INSERT MATERIAL : HIGH TEMP. UL94V-0.
3. CONTACT MATERIAL : PHOSPHOR BRONZE t=0.35 mm.
4. PLATING : GOLD PLATING OVER NICKEL.
5. OPERATING LIFE : 750 CYCLES MIN.
6. PCB RETENTION PRE-SOLDER : 1 LB MIN.
7. PCB RETENTION POST-SOLDER : 10 LBS MIN.

**ENVIRONMENTAL :**

1. STORAGE : -40°C TO +85°C.
2. OPERATION : -0°C TO +70°C.
3. Reflow Temperature: 255~265°C (5~10 Seconds)

MATES WITH MODULAR PLUG CONFORMING TO TIA-1096-A.

PART NUMBER : K392X-220-XX

- 1-3u" 2-6u"
- 3-15u" 4-30u"
- 5-50u" 7-Gold flash
- 01-DARK GRAY(NCS8500-N / Pantone 426C)

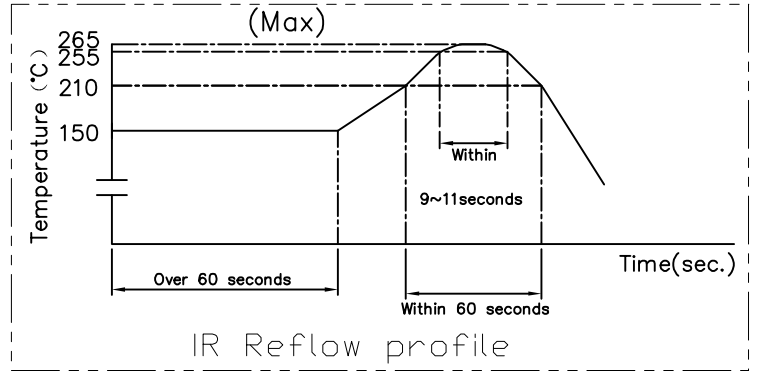

AXO	0066000	NEW DESIGN	JOY	111921
MARK	ECN-NO.	REVISION RECORD	DRAWN	DATE
		UNLESS OTHERWISE SPECIFIED TOLERANCES:	SCALE	CHECKED
		DIMENSIONAL TOLERANCE FOLLOWING:	1/1	
		X.X ±0.20	UNIT	APPROVED
		X.XX ±0.15	mm	
X.XXX ±0.10	SIZE	A3	SHEET	1/1
Contact Technology Co., Ltd.		ANGLE	±5°	
Material/Plated/Notes		NAME		
MATERIAL		1X2 SIDE ENTRY Cat.5e PCB JACK		
Tooling No.		PART NO.	SEE NOTE	REV. A
		DOC. NO.	KK390A220	