

RoHS

THIS IS A RoHS COMPLIANT COMPONENT/PRODUCT.

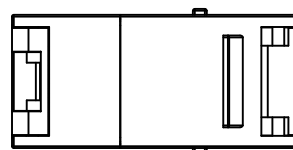
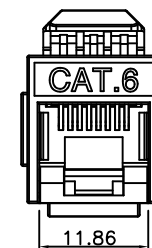
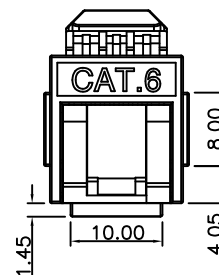
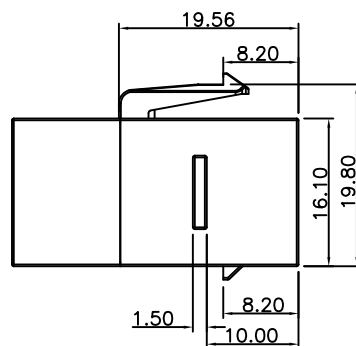
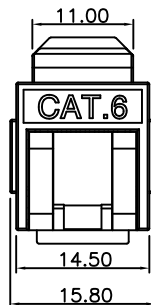
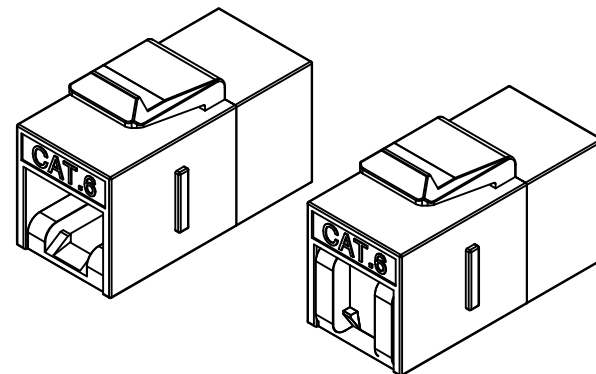
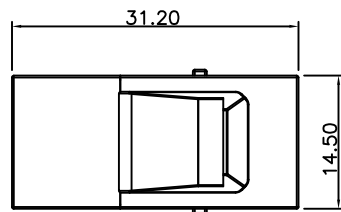

NOTES:

ELECTRICAL:

1. VOLTAGE RATING: 125 VAC RMS.
2. CURRENT RATING: 1.5 AMP.
3. CONTACT RESISTANCE: 100 MILLIOHMS MAX.
4. INSULATION RESISTANCE: 1000 MEGOHMS MIN @ 500 VDC.
5. DIELECTRIC STRENGTH: 750 VAC RMS 60Hz,1MIN.

ENVIRONMENTAL:

1. STORAGE: -40°C TO +85°C.
2. OPERATION: -40°C TO +85°C.

MECHANICAL:

- 1.HOUSING MATERIAL:PC UL94V-0
- 2.INSERT MATERIAL:PC UL94V-0
- 3.PCB MATERIAL:FR-4
- 4.CONTACT MATERIAL:PHOSPHOR BRONZE
- 5.SPRING MATERIAL:SPRING STEEL
- 6.PART NUMBER: N446X-040-0X

1-3u" 2-6u" 01: C6 WHITE
 3-15u" 4-30u"
 5-50u"

△XO	000000	NEW DESIGN	LONNY	040723'
MARK	ECN-NO.	REVISION RECORD	DRAWN	DATE
	UNLESS OTHERWISE SPECIFIED TOLERANCE		SCALE	CHECKED
	Dimension Range	Tolerance	1:1	APPROVED
	X.X	±0.20	UNIT	mm
	X.XX	±0.15	SIZE	A3
Contact Technology Co., Ltd.		ANGLE	±5°	SHEET 1/1
Material/Plated/Notes		NAME		
SEE NOTE		CAT.6 COUPLER W/ DUST COVER		
Tooling No.		PART NO.	SEE NOTE	REV. 0
		DOC. NO.	NN446A040	